



**CHRYSSAFIDIS**

## RUBINETTI, VALVOLE, SPECOLE, FILTRI

Cocks, valves, piping observatories, filters • Robinets, vannes, indicateurs, filtres

### PORTALIVELLO SUPERIORE A TENUTA CONICA CON ATTACCO GAS MASCHIO

Upper level gauge cock MALE GAS end • Porte-niveau supérieur avec attelage male GAS

#### 3.040.B9. --

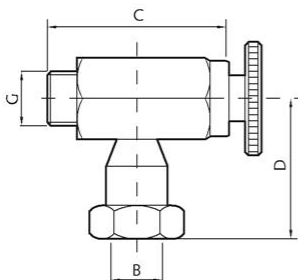

	G	B	CH	C	D	
	inch	mm	mm	mm	mm	kg
3.040.B1.05-A	3/8	14	30	68	56	0,45
3.040.B2.05-A	3/8	15	30	68	56	0,45
3.040.B3.05-A	3/8	16	30	68	56	0,45
3.040.B4.05-A	3/8	20	30	68	56	0,45
3.040.B1.08-A	1/2	14	30	68	56	0,45
3.040.B2.08-A	1/2	15	30	68	56	0,45
3.040.B3.08-A	1/2	16	30	68	56	0,45
3.040.B4.08-A	1/2	20	30	68	56	0,45
3.040.B5.08-A	1/2	24	30	68	61	0,60

### PORTALIVELLO INFERIORE A TENUTA CONICA CON ATTACCO GAS MASCHIO

Lower gauge cock, male GAS end • Porte-niveau inférieur avec attelage male GAS

#### 3.050.B9. --

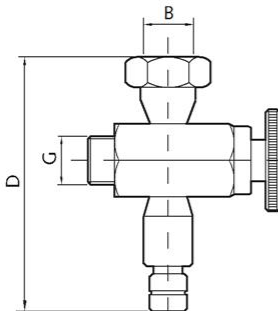

	G	B	CH	D	
	inch	mm	mm	mm	kg
3.050.B1.04-A	3/8	14	24	100	0,40
3.050.B2.04-A	3/8	15	24	100	0,40
3.050.B3.04-A	3/8	16	24	100	0,40
3.050.B4.04-A	3/8	20	24	100	0,40
3.050.B1.05-A	3/8	14	30	105	0,50
3.050.B2.05-A	3/8	15	30	105	0,50
3.050.B3.05-A	3/8	16	30	105	0,50
3.050.B4.05-A	3/8	20	30	105	0,50
3.050.B1.08-A	1/2	14	30	105	0,50
3.050.B2.08-A	1/2	15	30	105	0,50
3.050.B3.08-A	1/2	16	30	105	0,50
3.050.B4.08-A	1/2	20	30	105	0,50
3.050.B5.08-A	1/2	24	30	110	0,65