

Short Type Hose Couplings for Vapor and Liquid Service 3171, 3175, 3181, 3185 and 3195 Series

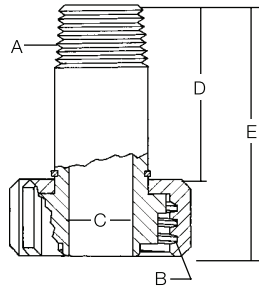

3175 Series



Style A
For Liquid Filling



A3185 Series

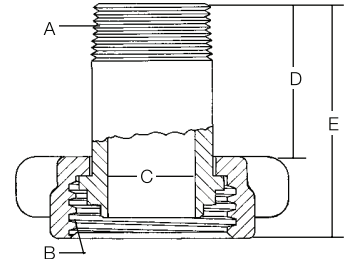

Style B
For Liquid Filling



3171A Series

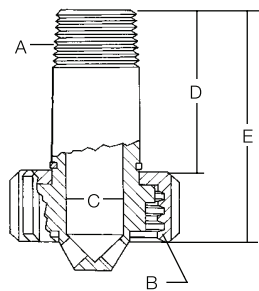

Style C
For Vapor Equalizing



3191 Series

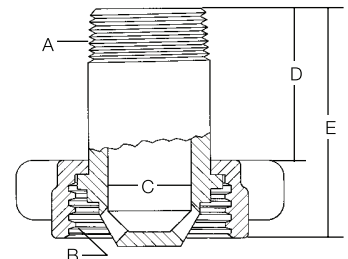

Style D
For Vapor Equalizing



Ordering Information

Part Number	Material	Style	A. Hose Connection (M. NPT)	B. Coupling Connection (F. ACME)	C. Tailpiece Bore	D. Hose End To Nut	E. Overall Length		
3175B	Brass	A	1/2"	1 1/4"	3/64"	1 1/16"	2 1/16"		
3175			3/4"		3/4"				
3175A			1"		15/16"				
3185	Brass Nut & Steel Nipple	B	1 1/4"	2 1/4"	1 3/16"	2 1/16"	3 3/4"		
3195			2"	3 3/4"	7/8"	2 1/4"	3 5/8"		
A3175			Steel	A	3/4"	1 1/4"	3/4"	2"	2 7/8"
A3175A	1"	7/8"			2 1/4"		3 1/8"		
A3185	B	1 1/4"			2 1/4"		1 1/4"	2 1/8"	3 3/16"
A3195		2"	3 3/4"	1 7/8"	2 1/4"	3 5/8"			
3171		Brass	C	3/8"	1 1/4"	3/8"	1 1/2"	2 13/32"	
3171A	1/2"			3 1/64"					
3181	3/4"			3/4"		1 3/16"			2 1/16"
3181A	1"			3/4"		1 1/8"			2 3/4"
3191	1 1/4"			2 1/4"		1 3/16"			2 1/8"